

Alloy Bolt Type Anchor Shackles

G-2140 / S-2140 ALLOY BOLT TYPE ANCHOR SHACKLES



G-2140 meets the performance requirements of Federal Specification RR-C-271D, Type IVA, Grade B, Class 3, except for those provisions required of the contractor. For additional information, see page 391.

- Quenched and Tempered.
- Alloy bows, Alloy bolts.
- Forged Alloy Steel 30 thru 175 metric tons. Cast Alloy Steel 200 thru 400 metric tons.
- Working Load Limit is permanently shown on every shackle.
- All sizes are individually proof tested to 2.0 times the Working Load Limit.
- Pins are galvanized and painted red.
- All sizes are **RFID EQUIPPED**.
- Shackles are Quenched and Tempered and can meet DNV impact requirements of 42 joules at -20 C.
- Crosby products meet or exceed all requirements of ASME B30.26 including identification, ductility, design factor, proof load and temperature requirements. Importantly, Crosby products meet other critical performance requirements including fatigue life, impact properties and material traceability, not addressed by ASME B30.26.
- Shackles 200 metric tons and larger are provided as follows.
 - Serialized Pin and Bow
 - Material Certification (Chemical)
 - Magnetic Particle Inspected.
 - Certification must be requested at time of order.
- Type Approval and certification in accordance with ABS 2006 Steel Vessel Rules 1-1-17.7, and ABS Guide for Certification of Cranes.

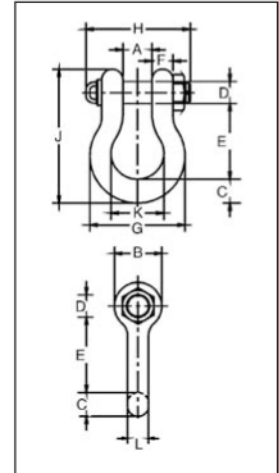

Nominal Shackle Size (in.)	Working Load Limit (t) [*]	Stock No.		Weight Each (lbs.)	Dimensions (in.)											Tolerance +/-	
		G-2140	S-2140		A	B	C	D	E	F	G	H	J	K	L	A	E
1-1/2	30	1021110	1021129	18.8	2.38	3.62	1.62	1.63	5.75	1.39	6.88	7.73	10.00	3.88	1.53	.13	.25
1-3/4	40	1021138	1021147	33.9	2.88	4.19	2.25	2.00	7.00	1.75	8.81	9.33	12.34	5.00	1.84	.13	.25
2	55	1021156	1021165	52.0	3.25	4.81	2.40	2.25	7.75	2.00	10.16	10.41	13.68	5.75	2.08	.13	.25
2-1/2	85	1021174	1021183	96.0	4.12	5.81	3.12	2.75	10.50	2.62	12.75	13.58	17.90	7.25	2.71	.25	.25
3	120	1021192	-	178.0	5.00	6.50	3.63	3.25	13.00	3.00	14.62	15.13	21.50	7.88	3.12	.25	.25
3-1/2	† 150	1021218	-	265.0	5.25	8.00	4.38	3.75	14.63	3.75	17.02	17.62	24.88	9.00	3.62	.25	.25
4	† 175	1021236	-	338.0	5.50	9.00	4.56	4.25	14.50	4.00	18.00	20.37	25.68	10.00	4.00	.25	.25
4-3/4**	† 200	1021414	-	450.0	7.25	10.50	6.00	4.75	15.63	3.75	21.00	21.21	29.25	11.00	4.50	.25	.25
5**	† 250	1021432	-	600.0	8.50	12.00	6.50	5.00	20.00	3.88	24.50	22.68	35.00	13.00	4.50	.25	.25
6**	† 300	1021450	-	775.0	8.38	12.00	6.75	6.00	19.50	4.75	25.00	25.06	35.25	13.00	5.00	.25	.25
7**	† 400	1021478	-	1102.0	8.25	14.00	7.25	7.00	22.50	6.50	26.00	28.68	40.25	13.00	6.00	.25	.25

* Note: Maximum Proof Load is 2.0 times the Working Load Limit. Minimum Ultimate Load is 4 times the Working Load Limit on 200 thru 400 metric Tons. For sizes 30 thru 175 metric Tons, Minimum Ultimate Load is 5.4 times the Working Load Limit.

** Cast Alloy Steel.

† Furnished with Round Head Bolts with welded handle.

For Working Load Limit reduction due to side loading applications, see page 74.

Load Rated

