

Eye Sling & Clevis Sling Hooks

A-327

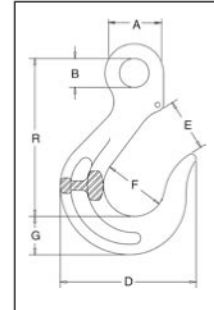

- Alloy Steel - Quenched and Tempered.
- Individually Proof Tested at 2-1/2 times the Working Load Limit with certification.
- S-4088 Latch Kit fits hooks.



A-327 Eye Sling Hook

Chain Size (in.)	A-327 Stock No.	Working Load Limit (lbs.)*	Weight Each (lbs.)	Dimensions (in.)							Replacement Latch Stock No.
				A	B	D	E	F	G	R	
9/32 (1/4)	1003764	3500	.81	1.34	.56	3.47	1.44	1.76	.90	3.72	1090250
3/8	1003773	7100	2.10	1.82	.75	4.56	1.78	2.24	1.25	4.83	1090251
1/2	1003782	12000	3.71	2.26	.94	5.50	2.12	2.50	1.55	5.67	1090252
5/8	1003791	18100	6.40	2.75	1.15	6.50	2.41	2.88	1.88	6.61	1090253
3/4	1003808	28300	9.80	3.26	1.34	7.36	2.69	3.27	2.16	7.64	1090254
7/8	1003817	34200	15.40	3.72	1.44	8.48	3.06	3.62	2.45	8.56	1090255

* Ultimate Load is 4 times the Working Load Limit.

A-339



- Alloy Steel - Quenched and Tempered.
- Individually Proof Tested at 2-1/2 times the Working Load Limit with certification.
- Pin locking requires no special tools.
- S-4088 Latch fits 3/4" & 7/8" hooks.

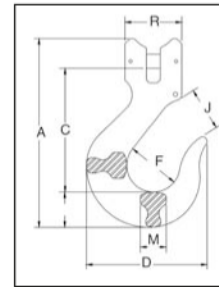

A-339 Clevis Sling Hook

Chain Size (in.)	(mm)	A-339 Stock No.	Working Load Limit (lbs.)*	Weight Each (lbs.)	Dimensions (in.)						
					A	C	D	F	G	J	M
3/4	19	1027793	28300	11.5	11.56	6.69	7.36	3.25	2.16	2.69	1.58
7/8	22	1027800	34200	17.7	13.13	7.61	8.48	3.63	2.45	3.06	1.75

* Ultimate Load is 4 times the Working Load Limit.

